



Vertical Sealess VS



★ **DISTRIBUTION**
CRYOSTAR

Technical Index

★ Pump ID Meaning

VS (model) 3 (Suction flange) x 2 (Discharge flange) x 7 (wheel diameter in inch)

Applications	Stationary pump for liquid transfer Road tankers
Liquids pumped	LCO ₂ , LIN, LAR, LNG
Drive type	Direct
Design pressure	25 bar / 365 PSI

★ Test Procedure

Each pump manufactured by CRYOSTAR is mechanically and cryogenically tested prior to shipment in our state-of-the-art testing facility to ensure that performance meets customer specification. The precision of measuring devices provides essential results : differential head, flow rate, seal gas consumption, pump efficiency, NPSH, noise and vibration levels – all documented and submitted to the customer.

★ Quality

Designed in compliance with guidelines like IGC 11/82 norm



★ Performance

Head (ft)

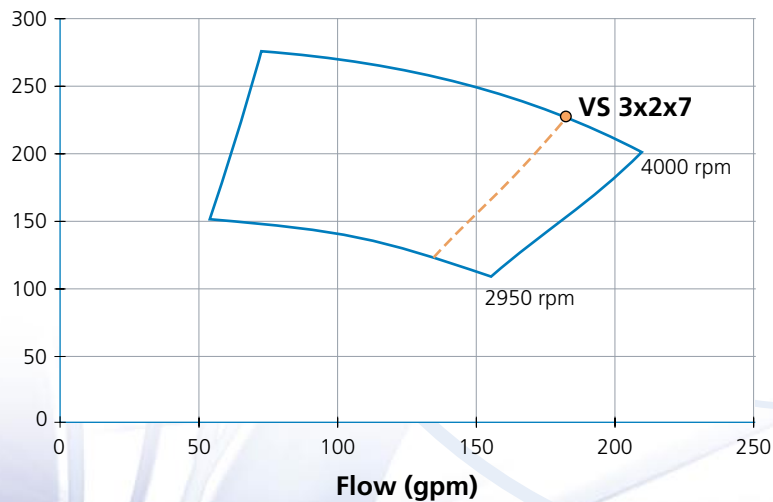

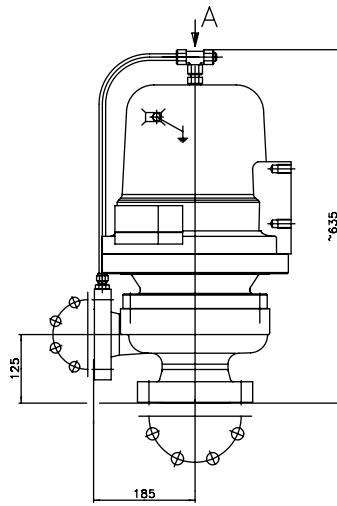

Vue A

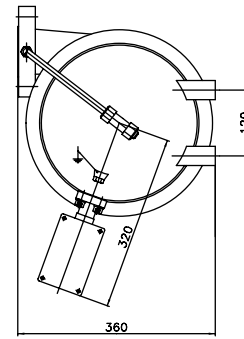

★ Features

- 1 Hermetically encapsulated pump eliminating the need for a shaft seal
 - 2 High hydraulic efficiency closed impeller
 - 3 Helical inducer allowing low required NPSH
 - 4 Special submerged electric motor cooled by the pumped fluid
 - 5 Motor bearings lubricated by the process fluid resulting in a "zero-maintenance" design
- ★ Pump low noise level

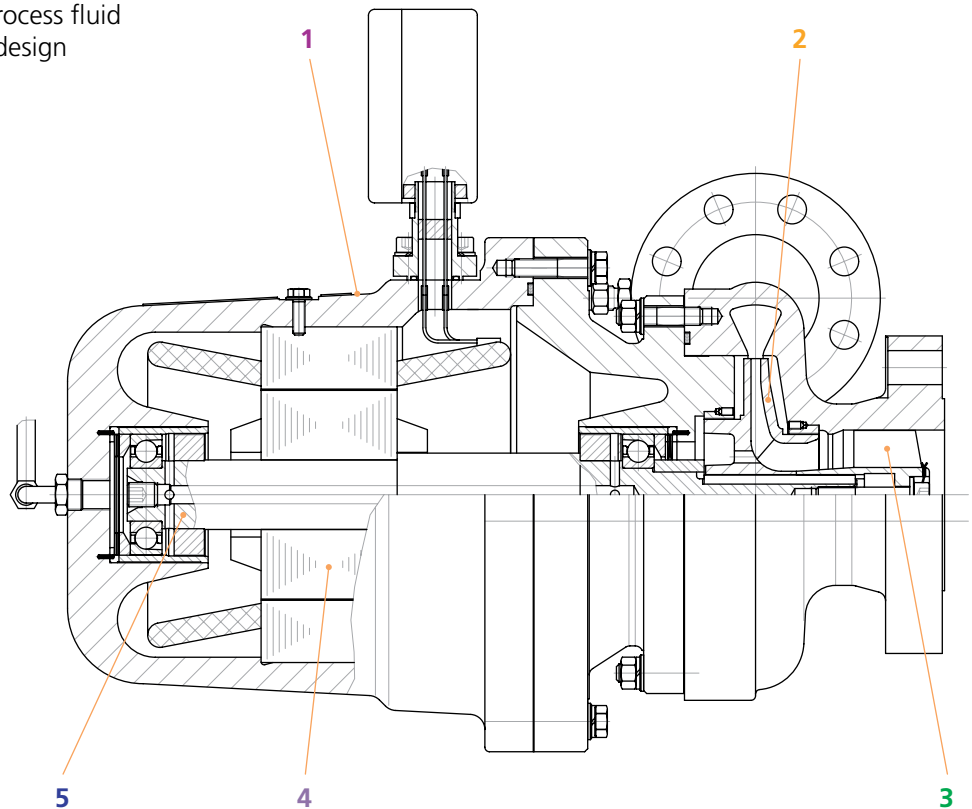

For more details please contact your local Cryostar representative



CRYOSTAR Automation	tel : +33 (0) 5 65 80 20 20	info@cryostar.com
CRYOSTAR Brazil	tel : +55 11 5092 5262	brazil@cryostar.com
CRYOSTAR China	tel : +86 571 8536 8331	china@cryostar.com
CRYOSTAR France	tel : +33 (0) 3 89 70 27 27	info@cryostar.com
CRYOSTAR Singapore	tel : +65 6276 7441	singapore@cryostar.com
CRYOSTAR UK	tel : +44 1709 702 777	uk@cryostar.com
CRYOSTAR USA East	tel : 1-800-483-1052	usa@cryostar.com
CRYOSTAR USA West	tel : +1 (562) 903-1290	usa@cryostar.com
CRYOSTAR USA - Houston Office	tel : +1 (713) 661-6000	usa.houston@cryostar.com



www.cryostar.com